

THE INFORMATION CONTAINED IN THIS DRAWING IS THE SOLE PROPERTY OF Q.E.D. ENVIRONMENTAL. ANY REPRODUCTION IN PART OR WHOLE WITHOUT THE WRITTEN PERMISSION OF Q.E.D. ENVIRONMENTAL IS PROHIBITED.

| ITEM | PART # | QTY. | DESCRIPTION |
|------|---------------|------|--------------------|
| 1 | CB38 | 6 | Carriage Bolt |
| 2 | RW50 | 6 | Retaining Washer |
| 3 | S38 | 6 | Spacer |
| 4 | w38 | 6 | Narrow Flat Washer |
| 5 | N38 | 6 | Hex Nut, Brass |
| 6 | 622-2-CP R1 | 3 | Clam Plate |
| 7 | 622-2-GA R1 | 5 | Rubber Gasket |
| 8 | 622-2-TP R1 | 1 | Top Plate |
| 9 | P-SS40-75-TBE | 1 | 3/4in NPT-M Port |
| 10 | COUP-SS-75 | 1 | 3/4in NPT Coupling |
| 11 | PLUG-SS-75 | 1 | 3/4in NPT-M Plug |

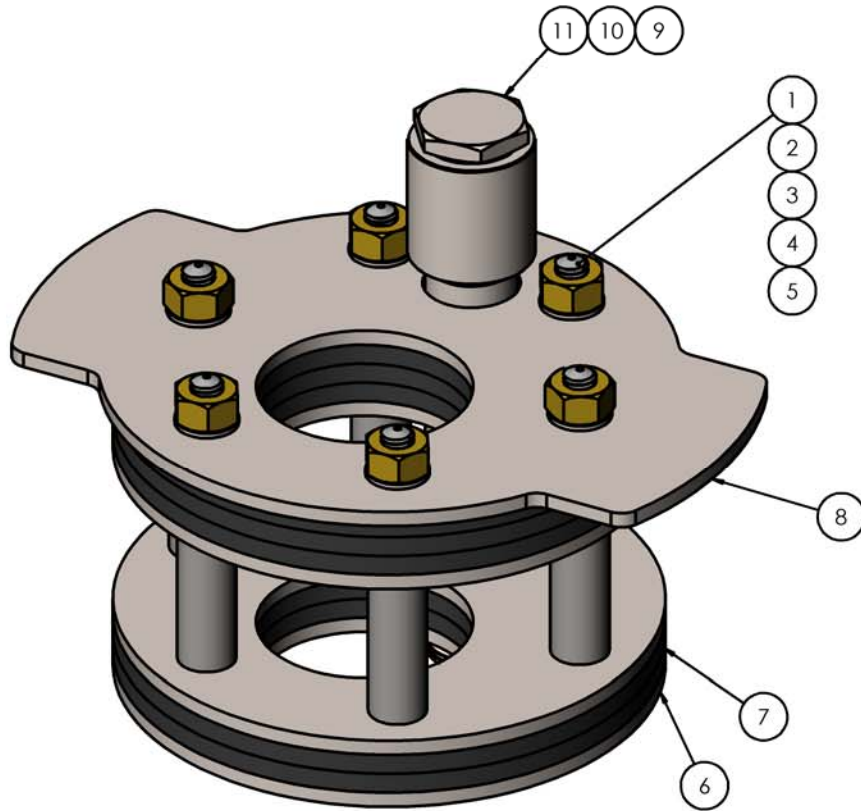

APPLICATION CONFIRMATION
WELL CAP IS DESIGNED FOR:
• 6 IN STEEL WELL CASING
APPROX INSIDE Ø 6.407 IN AS
MEASURED BY CUSTOMER

CUSTOMER INITIALS _____

UNLESS OTHERWISE SPECIFIED:
DIMENSIONS ARE IN INCHES
DIM & TOL STD 1 (ASME) & HOLE 1 (14.5-1984)
LENGTHS UNLESS OTHERWISE STATED 1 (ASME) (132015)
HOLE TOLERANCE STD 1 (ASME) (132015)
BURN & EDGES STD 1 (SAE)
THREADS STD 1 (ASME)
SURFACE ROUGHNESS STD 1 (ASME) (132015)
D-FINISH UNLESS OTHERWISE STATED

DRAWN BY IM DATE 02-02-17

CHECKED BY - DATE -

APPROVED BY - DATE -

NEXT ASSY - MATERIAL -
USED ON - FINISH -



TITLE
6in Well Cap Assembly
2in Gas Pipe 2 Ports

DWG. NO. 622-2-WCA-SUBM
SCALE 1:2 SHEET 1 OF 1